



Product feature

2/2-way Angle-Seat Valve,
manually operated, for
medium up to +180°C,
DN 15-50

1. Compact industrial design with long service life;
2. Adjustable flow rates;
3. Stainless steel valve body;
4. Excellent seat tightness due to PTFE soft sealing;

MV100 Series Manually-operated angle seat valve are designed with threaded or weld end port connection, There are 2 types function which is optional: usually MV100 is used only for On/Off function, control a defined flow is required with Model MV100A

Swivel plate type:
Parabolic plug
it can be used to control a
defined flow.

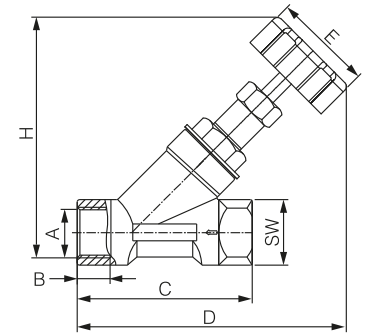

Specifications

Model specification	Specification
Mateial of body	CF8/CF8M
Port size	DN10-DN50
Seat seal	PTFE
Temp. of medium	-20~180°C
Installing	see following
Ambient and fluid	Air, Water, Oil, Steam, gas Organic solvent, acidic solution, weakly alkaline solution
Flow direction	Any flow direction (MV100A must be below seal)

Note: Installation in any orientation but preferably with the handwheel above

Dimensions

Port size	A	B	C	D	E	H	SW
DN10	3/8"	12	65	125	50	96	25
DN15	1/2"	14	76	125	50	105	28
DN20	3/4"	16	92	127	50/63	121	32
DN25	1"	21	103	137	63	128	39
DN32	1-1/4"	19	112	164	63	162	49
DN40	1-1/2"	21	129	167	63	165	56
DN50	2"	27	143	181	63	173	68

MV200 Series T Type Manual Right Globe Control Valve



Product feature

2/2-way Golbe Control Valve,
manually operated, for
medium up to +180°C,
DN 15-50

1. Compact industrial design with long service life;
2. Adjustable flow rates;
3. Stainless steel valve body;
4. Excellent seat tightness due to PTFE soft sealing;

MV200 Series Manually-operated globe control valve are designed as standard with threaded end port connection, There are 2 types function which is optional: usually MV200 is used only for On/Off function, control a defined flow is required with Model MV200A

Swivel plate type:
Parabolic plug
it can be used to control a
defined flow.

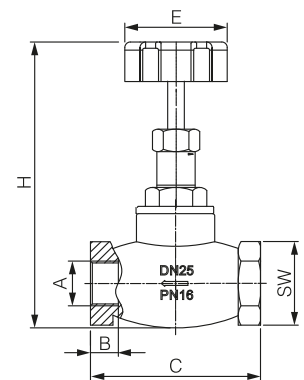

Specifications

Model specification	Specification
Mateial of body	CF8/CF8M
Port size	DN10-DN50
Seat seal	PTFE
Temp. of Medium	-20~180°C
Installing	see following
Ambient and fluid	Air, Water, Oil, Steam, gas Organic solvent, acidic solution, weakly alkaline solution
Flow direction	Any flow direction (MV200A must be below seal)

Note: Installation in any orientation but preferably with the handwheel above

Dimensions

Port size	A	B	C	E	H	SW
DN15	1/2"	12	57	50	114	26
DN20	3/4"	12	67	50	127	35
DN25	1"	12	72	50/63	135	42
DN32	1-1/4"	16	85	63	152	50
DN40	1-1/2"	16	98	63	262	56
DN50	2"	22	112	63	273	68

Valve

2P
2V
2W
2W(Big)
2WB
2WBF
US(2L)
DG223
DG523
0927/0955
PU220
PU225
VX
QX
PT
Q24 ³ / ₈ H
K23J ³ / ₈
K25J ³ / ₈
K25 ³ / ₈ H
K35 ³ / ₈ H
K23JD
K25JD
K25JK
PV100
PV200
PV300
PV400
PV500
PV700
PV800
PV1527
PVN
MV100
MV200
NAA
GT
K
R
FAL
FP-M
NTP
SX