

### Pressure Switch

T1030  
**T1050**  
 T1700  
 T1800  
 T2000W  
 PF08  
 PF08A  
 PF08V  
 PF20  
 PF20-V  
 PF25  
 PF26  
 PF37  
 PF701B  
 PF702  
 PF702A  
 PF702B  
 PF703A  
 PF704  
 PF704A  
 PF705  
 PF705A  
 PF705B  
 PF706  
 PF706A  
 PFDS10  
 PFDS63



### Product details

1. T1050 series are the cost effective products featuring mass production, low cost, extensive application for industrial and civil product.
2. It's widely used for measuring the pressure of gas and liquid, such as water, oil and mild corrosive liquid and gas.
3. The product is made of 1Cr18Ni9Ti stainless steel and with selected pressure sensing elements which is from well-known international brand.
4. The special circuits for V/I adaptor makes the zero and full range calibration more convenient.
5. Non-polar two-wire current and three-wire AC/DC voltage output are provided.
6. Customized structures and output formats can be designed according to special application requirements, in addition to standards products.

### Dimensions

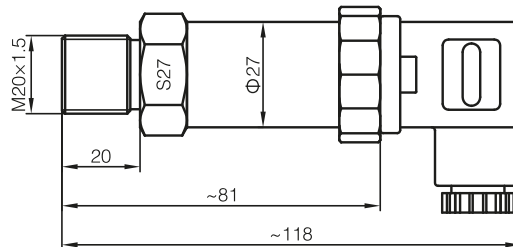

### Ordering code

|       |  |     |          |   |                   |   |                 |                |          |              |                      |    |            |   |                 |
|-------|--|-----|----------|---|-------------------|---|-----------------|----------------|----------|--------------|----------------------|----|------------|---|-----------------|
| T1050 |  | -   | A4       | - | 1.0               | - | M               | -              | 0.25     | -            | H                    | -  | G          | - | 1.0             |
|       |  |     | Output   |   | Measurement range |   | Unit of measure |                | Accuracy |              | Electrical connector |    | Pipe size  |   | Cable length(m) |
|       |  | A4  | 4~20mA   |   |                   | K | kPa             | 0.25 ±0.25%F.S |          | H DIN43650-A |                      | G  | G1/4       |   |                 |
|       |  | V05 | 0.5~4.5V |   |                   | M | MPa             | 0.5 ±0.5%F.S   |          | GX GX16-7    |                      | N  | NPT1/4     |   |                 |
|       |  | V0  | 0~5V     |   |                   | P | psi             |                |          | C Cable      |                      | R  | R1/4       |   |                 |
|       |  | V1  | 1~5V     |   |                   | B | bar             |                |          |              |                      | U  | 7/16-20UNF |   |                 |
|       |  | V10 | 0~10V    |   |                   |   |                 |                |          |              |                      | M  | M20×1.5    |   |                 |
|       |  |     |          |   |                   |   |                 |                |          |              |                      | N2 | NPT1/2     |   |                 |
|       |  |     |          |   |                   |   |                 |                |          |              |                      | G2 | G1/2       |   |                 |
|       |  |     |          |   |                   |   |                 |                |          |              |                      | R2 | R1/2       |   |                 |

### Specifications

| General                        | Value  |            |             |             |
|--------------------------------|--|------------|-------------|-------------|
| Measurement range              | 0~2...600bar   |            |             |             |
| Overload pressure              | 1.5 times of full scales   |            |             |             |
| Burst pressure                 | 3 times of full scales   |            |             |             |
| Accuracy                       | ±0.5%F.S   |            |             |             |
| Long term stability            | Typical value: 0.25%F.S    Maximum: 0.4%F.S                                    |            |             |             |
| Working temperature            | -40℃~85℃   |            |             |             |
| Compensated temperature        | -10℃~70℃   |            |             |             |
| Medium compatibility           | ALL Corrosive medium compatible with 1Cr18Ni9Ti                                |            |             |             |
| Output mode                    | Two-wire   | Three-wire |             |             |
| Output                         | 4~20mA   | 0.5~4.5V   | 0/1~5V      | 0~10V       |
| Power supply                   | 12~30VDC   | 5VDC       | 10~30VDC/AC | 12~30VDC/AC |
| Load resistance                | (U-10)/0.02(Ω)   | >100K(Ω)   |             |             |
| Insulation                     | >100M(Ω)@50V   |            |             |             |
| Electrical connection          | Packard, DIN 43650C, DIN72585, M12, Cable                                      |            |             |             |
| Pressure connection            | Male G1/4, G1/2, NPT1/4, NPT1/2, M20×1.5                                       |            |             |             |
| Response time                  | 10ms   |            |             |             |
| Pressure form                  | Gauge pressure   |            |             |             |
| Electro magnetic compatibility | Electromagnetic transmit: EN50081-1/-2; Electromagnetic sensitivity: EN50082-2 |            |             |             |

Conversion: 1bar=14.5psi, 1MPa=10bar