



Product details

1. T1700 series pressure transmitter is used for absolute vacuum measuring control, which has fully solved the problem of difficult vacuum measurement.
2. All the existing pressure connections and electrical connections are available for T1700 series pressure transmitter.

Features

1. Optional accuracy: $\pm 0.25\%F.S$, $\pm 0.5\%F.S$
2. Can be customized with the brand for OEM use
3. Acceptable for MOQ from one unit
4. Flexible pressure ranges and output options
5. No-polar two-wire current output
6. AC/DC voltage output

Dimensions

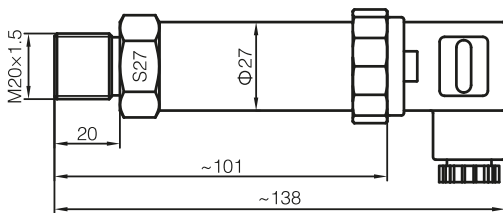

Applications

Atmospheric measurement, Aerospace and nautical field, Packing machinery, Petro-chemical, Meteorology monitoring, Automatic inspection system, Air pressure test in the mine ventilation system, high buildings management

Ordering code

T1700	-	A4	-	1.0	-	M	-	0.25	-	H	-	G	-	1.0
		Output		Measurement range		Unit of measure		Accuracy		Electrical connector		Pipe size		Cable length(m)
		A4	4~20mA			K	kPa	0.25	$\pm 0.25\%F.S$	H	DIN43650-A	G	G1/4	
		V0	0~5V			M	MPa			GX	GX16-7	N	NPT1/4	
		V1	1~5V			P	psi			C	Cable	R	R1/4	
		V10	0~10V			B	bar					U	7/16-20UNF	
												M	M20x1.5	
												N2	NPT1/2	
												G2	G1/2	
												R2	R1/2	

Specifications

General	Value		
Measurement range	Absolute pressure 0.1.....400bar		
Overload pressure	1.5 times of full scales		
Burst pressure	3 times of full scales		
Accuracy	±0.25%F.S, ±0.5%F.S		
Stable	Typically: 0.25%F.S Max: 0.4%F.S		
Medium temperature range	-40℃~85℃ (-40℃~125℃ is available on request)		
Compensated temperature	-10℃~70℃		
Medium	Compatible with stainless steel 1Cr18Ni9Ti		
Electrical overview	2 wire	3 wire	
Output	4~20mA	0~5V	0~10V
Power supply	10~30VDC	6~24VDC/10~36VAC	11~30VDC/20~36VAC
Load	(U-10)/0.02(Ω)	>100K(Ω)	
Insulation reistance	>100M(Ω)@50V		
Electrical connection	DIN43650, Protecting class IP65		
	GX16-7, Protecting class IP45		
	Waterproof wire lead (Class 5), Protecting class IP68		
Pressure connection	M20×1.5, G1/2, G1/4, NPT1/4, NPT1/2		
Response time	10ms		
Electro magnetic compatibility	EN50081-1/-2; EN50082-2		

Conversion: 1bar=14.5psi, 1MPa=10bar

Pressure Switch

T1030

T1050

T1700

T1800

T2000W

PF08

PF08A

PF08V

PF20

PF20-V

PF25

PF26

PF37

PF701B

PF702

PF702A

PF702B

PF703A

PF704

PF704A

PF705

PF705A

PF705B

PF706

PF706A

PFDS10

PFDS63