

Pressure Switch

T1030
T1050
T1700
T1800
T2000W
PF08
PF08A
PF08V
PF20
PF20-V
PF25
PF26
PF37
PF701B
PF702
PF702A
PF702B
PF703A
PF704
PF704A
PF705
PF705A
PF705B
PF706
PF706A
PFDS10
PFDS63



Product details

1. T1800 high temperature spray-diaphragm pressure transmitter is a product which is characterized by high temperature-proof, wide range and high accuracy.
2. It is widely used in testing gas and liquid pressure, such as water, oil, light hazardous liquid and gas.
3. Spray-diaphragm core refers to spray an insulation layer on the core by chemical method.
4. Then wheatstone bridge of metal diaphragm type and temperature compensation are sprayed on the insulated body.
5. At last, cover a layer of insulation material on the metal diaphragm resistance.
6. The wheatstone bridge of metal diaphragm will deform in accordance with the core deformation, which is affected by pressure and give a linear output.

Features

1. ± 0.1 , ± 0.25 , $\pm 0.5\%$ F.S accuracy
2. Spray-diaphragm core
3. 150°C proof- temperature
4. Entirely welding without O-ring
5. Various connector and pressure connection
6. Non-polar two wire system currency output

Applications

Engineering plant, motor engine, high pressure common rail engine, high and low temperature environment, deep well oil pressure measure, boiler pressure checking, natural gas storage equipment and hydraulic lubrication.

Dimensions

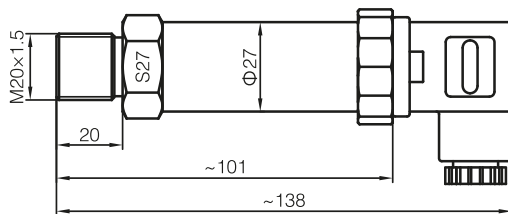

Ordering code

T1800	- A4	- 100	- K	- 0.25	- H	- GF	- 1.0
	Output	Measurement range	Unit of measure	Accuracy	Electrical connector	Pipe size	Cable length(m)
	A4 4~20mA		K kPa	0.25 $\pm 0.25\%$ F.S	H DIN43650-A	GF G1/4	
	V0 0~5V		M MPa	0.5 $\pm 0.5\%$ F.S	GX GX16-7	GM G1/4 male screw	
	V1 1~5V		P psi		C Cable	M M20x1.5	
	V10 0~10V		B bar		CW Waterproof joint qualification	RG $\Phi 8$ air faucet	

Specifications

General	Value		
Measurement range	0~1.....2000bar		
Overload capability	2 times of full scales		
Burst pressure	4 times of full scales		
Accuracy	$\pm 0.1\%$ F.S, $\pm 0.25\%$ F.S, $\pm 0.5\%$ F.S		
Stable	Typically: 0.25%F.S per year, 0.4%F.S(Max) per year		
Medium temperature range	-50°C~150°C (-50°C~230°C is available on request)		
Compensated temperature	-20°C~120°C		
Medium	Liquid and gas, compatible with stainless steel 1Cr18Ni9Ti		
Electrical overview	2 wire	3 wire	4 wire
Output	4~20mA	0~20mA 0~10mA	0~5/10V
Power supply	12~30VDC	12~30VDC	12~30VDC
Load	(U-10)/0.02(Ω)	(U-10)/0.02(Ω)	>20K(Ω)
Insulation resistance	>100M(Ω)@50V		
Insulation voltage	500V@60 second		
Vibration / Constant shock	10g/5~2000Hz, axes X/Y/Z 20g sine 11ms		
Life	2x10 ⁶ cycles @25°C		
Electrical connection	DIN43650C, M12 Series, Packard, Cable		
Pressure connection	M20x1.5, G1/4, G1/2, R1/2, NPT1/2, NPT1/4		
Pressure type	Gauge, Seal gauge, Absolute		
Electro magnetic compatibility	EN50081-1/-2, EN50082-2		

Conversion: 1bar=14.5psi, 1MPa=10bar