

Pressure Switch

T1030
T1050
T1700
T1800
T2000W
PF08
PF08A
PF08V
PF20
PF20-V
PF25
PF26
PF37
PF701B
PF702
PF702A
PF702B
PF703A
PF704
PF704A
PF705
PF705A
PF705B
PF706
PF706A
PFDS10
PFDS63



Product details

1. The PF08 switches are fixed set point, factory calibrated pressure switches.
2. It is automatic reset, and can be normally open or normally close contacts.
3. All metallic wetted components make the PF08 switch compatible with a multitude of chemicals in liquid or gas form.
4. It is offered numerous types of electrical terminations from different size and style push on terminals to wire leads with an array of standard industry connectors.
5. In house machining capabilities allows Dg-pnetic to offer a wide variety of pressure fitting from different thread types and sizes to units with internal deflator and copper tubing for sawing operations.

Dimensions

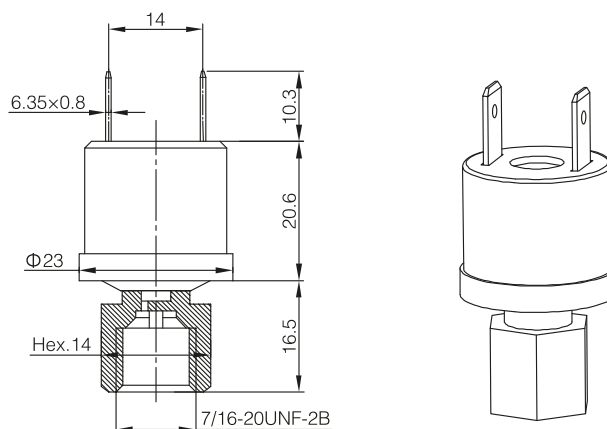

Typical application

1. Air conditioning units (Residential, commercial and automotive)
2. Refrigeration
3. CO2 Air conditioning, CO2 refrigeration
4. Heat pumps
5. High pressure cut off, low pressure cut off
6. Air brakes (Trucks and commercial equipment)
7. Fuel pressure monitoring
8. Engine controls
9. Agricultural equipment
10. Industrial controls
11. Marine engine / equipment

Ordering code

PF08	A	B	C	D	145-175psi
	Circuitry	Base material	Connection	Electrical connections	Pressure setting
	SPST-NC	Brass	1/8NPT	6.35x0.8	145psi Reset pressure
	SPST-NO	Plated steel	1/4NPT	4.8x0.8	175psi Action pressure
	SPDT		R1/8	18AWG Wire leads	
			R1/4		
			G1/8		
			G1/4		
			1/4 Copper tube		
			7/16UNF Male		
			7/16UNF Female		
			7/16UNF Female with deflector		

Specifications

Model	PF08		
Media	Air, Water, Motor oils, Transmission oils, Hydrocarbon media, Refrigeration fluid		
Pressure range/ Tolerance/ Proof pressure	Pressure range	Tolerance	Proof pressure
	0.2~6bar (low pressure)	±0.5bar	15bar
	6~10bar	±0.7bar	35bar
	11~20bar	±1bar	45bar
	21~30bar	±1.5bar	
	31~45bar	±1.5bar	
Operating temperature range	Environment temperature: low pressure: -30~65°C, High pressure: -35~120°C;		
Switch type	SPST (NC OR NO); SPDT		
Electric rating	120/240Vac 375VA		
Endurance	100000		
Connection	Please see the selection table (Customizable)		
Electrical connections	6.35x0.8; 4.8x0.8; Wire connection (Can be customized length and electrical plug)		

Conversion: 1bar=14.5psi, 1MPa=10bar



Product details

- 1. PF08A is an overloaded pressure switch, the maximum pressure can be up to 750 PSI and the maximum rated current can be 25A.
- 2. The contact arrangement can be normal close or normal open.
- 3. It can be used in the refrigerating unit, all kinds of air conditioner, air compressor, oil pump and other commercial equipment which need the protection of the pressure system by adjusting the fluid pressure automatically.

Dimensions

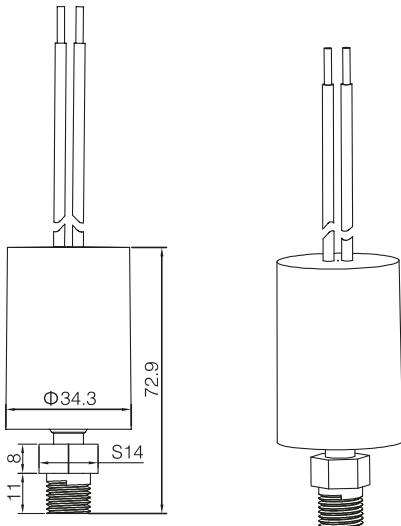

Ordering code

PF08A	-	A		B		C		D	-	145-175psi
		Circuitry		Base material		Connection		Electrical connections		Pressure setting
		SPST-NC		Brass		1/8NPT		6.35×0.8		145psi
		SPST-NO		Plated steel		1/4NPT		16AWG Wire leads		Reset pressure
		SPDT				R1/8		14AWG Wire leads		175psi
						R1/4				Action pressure
						G1/8				
						G1/4				
						1/4 Copper tube				
						7/16UNF Male				
						7/16UNF Female				
						7/16UNF Female with deflector				

Specifications

Model	PF08A		
Media	Air, Water, Refrigerant, Oils, Lubricant, and another similar hydrocarbon		
Pressure range/ Tolerance/ Proof pressure	Pressure range	Tolerance	Proof pressure
	0.2~6bar (low pressure)	±0.5bar	15bar
	6~10bar	±0.7bar	35bar
	11~20bar	±1bar	45bar
	21~30bar	±1.5bar	
	31~45bar	±1.5bar	
Burst pressure	5000psi		
Operating temperature range	Environment temperature: Low pressure: -30~65℃, High pressure: -35~120℃; Medium temperature: -50~120℃;		
Switch type	SPST (NC OR NO); SPDT		
Electric rating	120VAC, 13FLA, 65LRA; 240VAC, 10FLA, 45LRA; 480VAC, 4FLA, 24LRA		
	120/240VAC, 480/720VA; 28VDC, 15AMP; 24VAC, 125VA		
Service life	100000		
Pressure interface	Please see the selection table (Customizable)		
Electrical connections	6.35×0.8; Wire connection (Can be customized length and electrical plug)		

Conversion: 1bar=14.5psi, 1MPa=10bar

Pressure
Switch

T1030

T1050

T1700

T1800

T2000W

PF08

PF08A

PF08V

PF20

PF20-V

PF25

PF26

PF37

PF701B

PF702

PF702A

PF702B

PF703A

PF704

PF704A

PF705

PF705A

PF705B

PF706

PF706A

PFDS10

PFDS63

Pressure Switch

T1030
T1050
T1700
T1800
T2000W
PF08
PF08A
PF08V
PF20
PF20-V
PF25
PF26
PF37
PF701B
PF702
PF702A
PF702B
PF703A
PF704
PF704A
PF705
PF705A
PF705B
PF706
PF706A
PFDS10
PFDS63



Product details

1. PF08-V vacuum switch is automatic reset pressure switch designed, there is deadband between close and open pressure setpoint.
2. It can be used for vacuum pressure controlling for vacuum tank, refrigerating equipment or room cooler units or remote outdoor condensing units for domestic cooling systems.

Dimensions

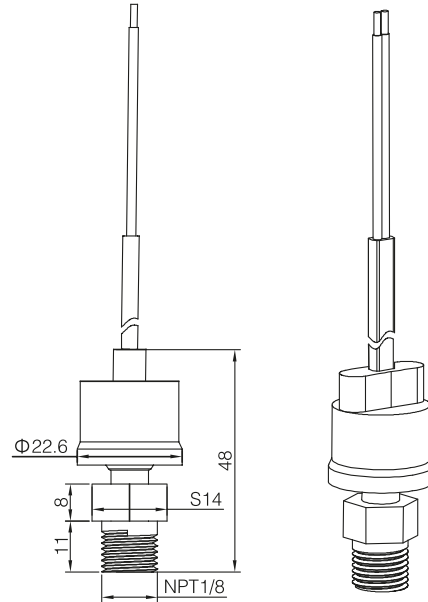

Typical application

Safety controls / air conditioning / refrigeration / vacuum tank pressure control / braking system of automobile

Ordering code

PF08V	A	B	C	D	0.4-0.75bar
	Circuitry	Base material	Connection	Electrical connections	Pressure setting
	SPST-NC	Brass	1/8NPT	6.35×0.8	0.4bar Reset pressure
	SPST-NO	Plated steel	1/4NPT	18AWG Wire harness	0.75bar Action pressure
			G1/8	Protective sleeve	
			G1/4		
			Custom-made		

Specifications

Model	PF08V		
Media	Air, Water, Motor oils, Transmission oils, Hydrocarbon media, Refrigeration fluid		
Pressure range/ Tolerance	Action pressure	Reset pressure	Tolerance
	-0.5~-0.8bar	-0.25~-0.6bar	±0.05bar
	Differential pressure ≥ 0.25 bar		
Burst pressure	10bar		
Operating temperature range	Environment temperature: -20~65℃		
Switch type	SPST (NC OR NO)		
Electric rating	120Vac 6FLA, 40.2 LRA; 240Vac 4FLA, 26LRA		
	120/240Vac 375VA; 36Vdc 3A		
Endurance	300000		
Connection	Please see the selection table (Customizable)		
Electrical connections	6.35×0.8; Wire connection (Can be customized length and electrical plug)		

Conversion: 1bar=14.5psi, 1MPa=10bar



Product details

1. The PF20 hot tub pressure switch is specifically designed to stand up to extended duty applications.
2. This switch is factory set but capable of field adjustment.
3. It features different diaphragms for compatibility with a wide variety of fluids, and various terminations including a Metri-Pack connector that forms a tight seal when connected.
4. Among the outstanding design benefits are its durable construction, compact size, and enhanced set point integrity.
5. It can be widely used for pool and spa, anti-skid braking systems, water pump systems, and dental air compressors, heavy construction, off road equipments and other pressure control systems.

Dimensions

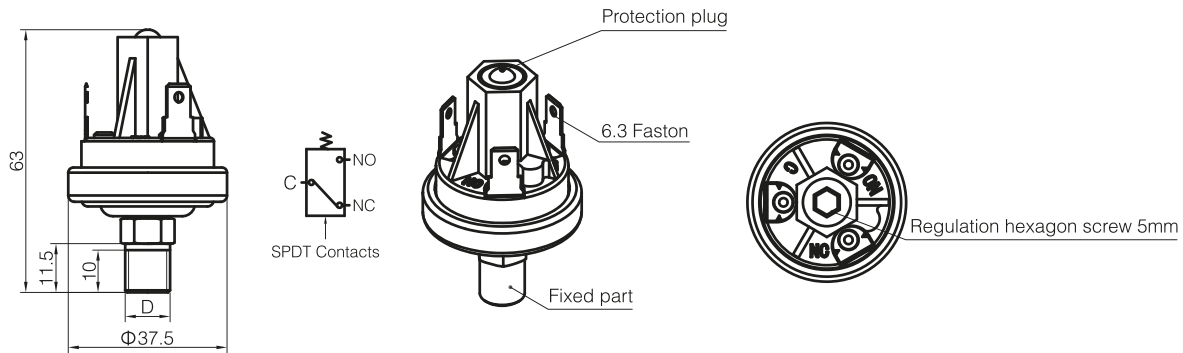

Ordering code

Pressure set point range	Circuitry	Base material	Connection	Terminals	Cover	Pressure setting
0.5-1psi±0.3psi	SPST-NC	Brass	1/8NPT	1/4 Blade	None	10psi
1.1-3psi±0.5psi	SPST-NO	Plated steel	1/4NPT	#8-32 Scerws	Cover A	
3.1-7psi±1psi	SPDT-NO-C-NC	Stainless steel	R1/8	Wire leads	Cover B	
8-13psi±2psi	SPST-NO(Adjustable)		R1/4			
14-4psi±3psi	SPDT-NO-C-NC(Adjustable)		G1/8			
25-50psi±5psi			G1/4			
51-90psi±7psi						

Specifications

Model	PF20
Media	Air, water, motor oils, transmission oils, jet fuels and other similar hydrocarbon media
Pressure set point	Factory set from 0.5 to 150psi
Max operating pressure	150psi for 0.5-24psi set point range, 250psi for 25-150psi set point range
Proof pressure	500psi
Burst pressure	750psi for 0.5-24psi set point range, 1250psi for 25-150psi set point range
Opreating temperature range	-40°C to +120°C
Switch type	Direct action, blade contact
Electric rating	Resistive: 15AMP-6VDC, 8AMP-12VDC, 4AMP-24VDC
	Inductive: 1AMP-120VAC, 0.5AMP-240VAC
Contact arrangement	SPST-N.O,N.C 1circuit adjustable dual circuit, or 2circuits adjustble dual circuit. Also available are N.O/N.O. dual circuit and N.C/N.C. dual circuit
Terminal	#8-32 Screws, 1/4" Blade
Connection	1/8-27NPT Male
Material	Contact: silver alloy, gold plated; Base: brass; Cover: glass reinforced polyester; Diaphragm: polyimide film
Options	Plated steel, plastic or stainless steel base; Various base connector thread size;
	Wire leads (Potted & sealed); Teflon or EPDM diaphragm

Conversion: 1kgf/cm²=14.2psi 1bar=14.5psi

Pressure
Switch

T1030

T1050

T1700

T1800

T2000W

PF08

PF08A

PF08V

PF20

PF20-V

PF25

PF26

PF37

PF701B

PF702

PF702A

PF702B

PF703A

PF704

PF704A

PF705

PF705A

PF705B

PF706

PF706A

PFDS10

PFDS63

Pressure Switch
T1030
T1050
T1700
T1800
T2000W
PF08
PF08A
PF08V
PF20
PF20-V
PF25
PF26
PF37
PF701B
PF702
PF702A
PF702B
PF703A
PF704
PF704A
PF705
PF705A
PF705B
PF706
PF706A
PFDS10
PFDS63



Product details

- 1. PF20-V vacuum switch is specifically designed to stand up to extended duty applications.
- 2. This switch is factory set. It features a fluorosilicone rubber diaphragm for compatibility with a wide variety of fluids, and various terminations including a Metri-Pack connector that forms a tight seal when connected.
- 3. Among the outstanding design benefits are its durable construction, compact size, and enhanced set point integrity.

Dimensions

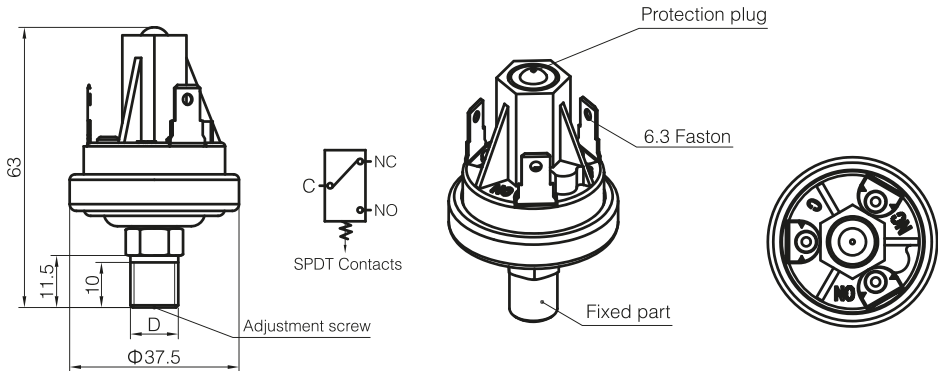

Ordering code

PF20	-	V	-	4		A		B		C		D		E	-	20"Hg
Pressure set point range						Circuitry		Base material		Connection		Terminals		Cover		Pressure setting
1.1-3"Hg(15-41"H2O)±0.5"Hg						SPST-NC		Brass		1/8NPT		1/4 Blade		None		20"Hg
4-8"Hg±1"Hg						SPST-NO		Plated steel		1/4NPT		#8-32 Scerws		Cover A		
9-17"Hg±2"Hg								Stainless steel		R1/8		Wire leads		Cover B		
18-22"Hg±3"Hg										R1/4						
										G1/8						
										G1/4						

Specifications

Model	PF20-V
Media	Air
Pressure set point	Factory set from 1.1 to 22 in/Hg Vacuum
Max operating pressure	30 in/Hg Vacuum
Burst pressure	150 psi
Opeating temperature range	-40℃ to +120℃
Switch type	Direct action, blade contact
Electric rating	Resistive:15AMP-6VDC, 8AMP-12VDC, 4AMP-24VDC
	Inductive:1AMP-120VAC, 0.5AMP-240VAC
Contact arrangement	SPST-NO, NC
Terminal	#8-32 Screws, 1/4" Blade, Metri-Pack
Connection	1/8"NPT Male, 1/4"NPT Male, G1/8" Male, G1/4" Male
Material	Contact: silver alloy, gold plated; Base: plated steel; Cover: glass reinforced polyester; Diaphragm: fluorosilicone elastomer
Options	Various base connector sizes, wire leads (Potted & sealed)

Conversion: 1kgf/cm²=14.2psi 1bar=14.5psi 1 in/Hg=0.49psi



Product details

- 1. PF25 Steam pressure switch is designed for control pressure with higher current capacity.
- 2. It is widely used in steam cleaner, steam sadiron and other pressure control system.
- 3. It provides SPST or SPDT contact form and switch deadband (Also referred to as mechanical differential or hysteresis).
- 4. PF25 switch utilize high-quality miniature snap-action switches.
- 5. The switch is diaphragm operated.
- 6. Diaphragm material can be selected for the operating medium, temperature range and other parameters.
- 7. During the development of a specification, actuation point can be adjusted by the designer. In production, factory setting is required.

Dimensions

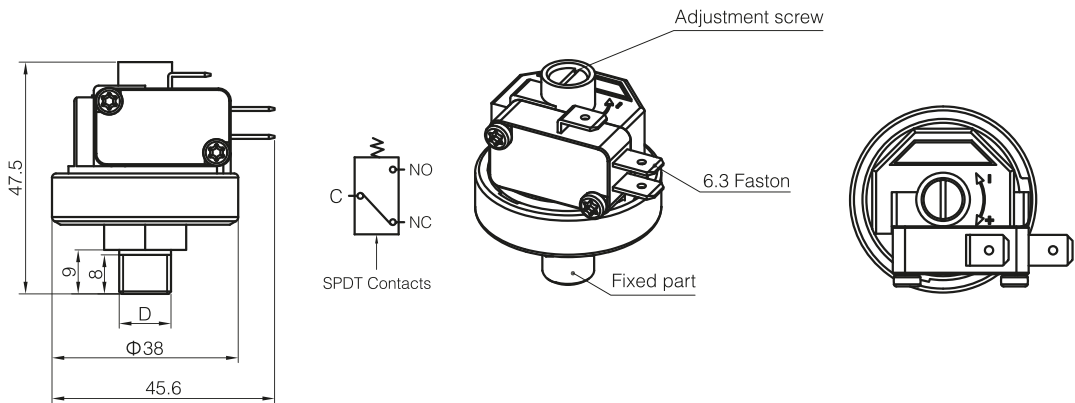

Ordering code

PF25	-	4	A	B	C	-	3.5bar
		Pressure range	Connection type (Male)	Electrical rating	Max operating temperature	Pressure setting	
		0.2-0.6bar	1/8NPT	16A, 125-250VAC	85°C	Factory set at 3.5bar	
		0.5-1.0bar	1/4NPT	22A, 125-250VAC	125°C		
		1.0-2.5bar	R1/8				
		2.0-4.0bar	R1/4				
		3.0-7.0bar	G1/8				
		5.0-9.0bar	G1/4				

Specifications

Model	PF25					
Media	Non hazardous gas, liquid or steam					
Operating pressure	0.2-0.6bar	0.5-1.0bar	1.0-2.5bar	2.0-4.0bar	3.0-7.0bar	5.0-9.0bar
Proof pressure	3bar	3bar	10bar	10bar	10bar	10bar
Opeatihg temperature range	+125°C Max imum					
Contact arrangement	SPST or SPDT					
Electric rating	SPST or SPDT/Normal close: 16(4)-250VAC (Other ratings are available if necessary)					
Terminal	6.3 or 4.8mm male Q.C. Insulation cover is available if necessary					
Connection	1/8NPT-27 or 1/4NPT-18 Male (Other connection is optional)					

Conversion: 1kgf/cm²=14.2psi 1bar=14.5psi

Pressure Switch

T1030

T1050

T1700

T1800

T2000W

PF08

PF08A

PF08V

PF20

PF20-V

PF25

PF26

PF37

PF701B

PF702

PF702A

PF702B

PF703A

PF704

PF704A

PF705

PF705A

PF705B

PF706

PF706A

PFDS10

PFDS63

Pressure Switch
T1030
T1050
T1700
T1800
T2000W
PF08
PF08A
PF08V
PF20
PF20-V
PF25
PF26
PF37
PF701B
PF702
PF702A
PF702B
PF703A
PF704
PF704A
PF705
PF705A
PF705B
PF706
PF706A
PFDS10
PFDS63



Product details

1. PF26 is a compact pressure switch capable of sensing pressure range from as low as 0.2 bar up to 6bar and 10bar. The switching mechanism is an internal snap action switch offering high current capacities with options of SPST, SPDT, normally open and normally closed contacts.
2. It can be widely used in applications, where pressure of air, steam, gas, water etc. need to be controlled accurately and hysteresis is required.

Dimensions

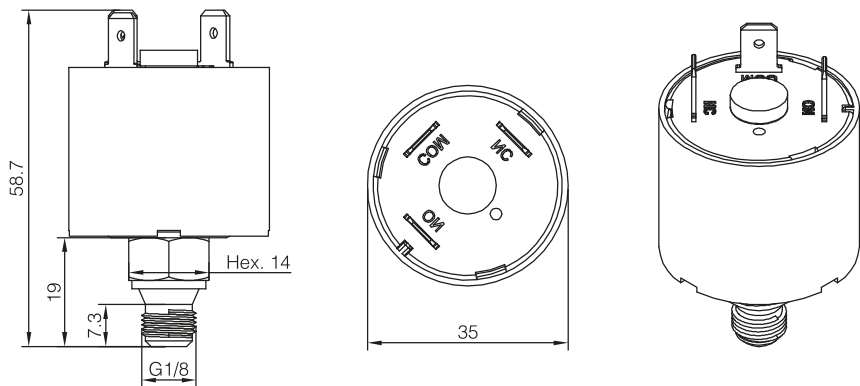

Ordering code

PF26	—	A		B		C		3.5bar
		Pressure range		Connection type (Male)		Differential		Pressure setting
		0.2-6bar		1/8NPT		Fixed 0.1-0.4bar		Factory set at 3.5bar
		0.2-10bar		1/4NPT		Adjustable 0.2-0.8bar		
				R1/8				
				R1/4				
				G1/8				
				G1/4				

Specifications

Model	PF26	
Media	Non hazardous gas, liquid or steam	
Operating pressure	0.2-6bar	0.2-10bar
Proof pressure	12bar	
Differential	Fixed 0.1-0.4bar; Adjustable 0.2-0.8bar	
Operating temperature range	+ 125℃ Maximum	
Contact arrangement	SPST or SPDT	
Electric rating	Normally closed: NC 15A resistance load, 1.5 inductive load/250V Normally open: NO 9A resistance load, 0.9 inductive load/250V	
Terminal	6.3 mm male Q.C. Insulation cover is available if necessary	
Connection	G1/8 or G1/4 Male (Other connection is optional)	

Conversion: 1kgf/cm²=14.2psi 1bar=14.5psi



Product details

- 1. PF37 diaphragm pressure switch is available for various sumps, effluent, and sewage application to control the liquid level.
- 2. Various switch settings are available for to turn-on or turn-off the pump.
- 3. The diaphragm pressure sensing design make it more reliable than traditional float ball mechanism.
- 4. Port connection design make it can sense the pressure without immersing the liquid directly.

Dimensions

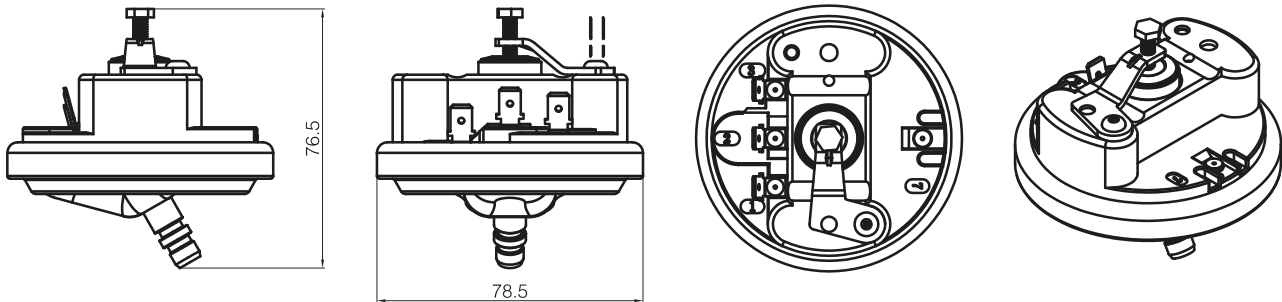

Ordering code

PF37	-	A		B		C	-	4.5"-6"H ₂ O
		Connection type		Contact Arrangement		Enclosure		Pressure setting
		Diaphragm		SPDT		None enclosure		Cut in 6"H ₂ O
		Φ6mm for tube		SPST-NO		With enclosure		Cut off 4.5"H ₂ O
		1/4NPT		SPST-NC				

Specifications

Model	PF37
Media	Air, water or other non-hazardous liquid
Basic function	Diaphragm pressure switch operation: provide water level signals to appliance control, level value can be set on customer request
Pressure range liquild level range	2~60 in W.C.
Proof pressure	5psi
Contact type	SPDT, SPST-NC/NO
Electric rating	12/13.8A, 125VAC 10A, 250VAC 1/2HP, 125/250VAC 3/4HP, 125/250VAC
Ambient temperature	40℃
Terminal	6.3mm×0.8 Blade

Conversion: 1mbar=100Pa 1"W.C.=249Pa

Pressure Switch

T1030

T1050

T1700

T1800

T2000W

PF08

PF08A

PF08V

PF20

PF20-V

PF25

PF26

PF37

PF701B

PF702

PF702A

PF702B

PF703A

PF704

PF704A

PF705

PF705A

PF705B

PF706

PF706A

PFDS10

PFDS63

Pressure Switch

T1030
T1050
T1700
T1800
T2000W
PF08
PF08A
PF08V
PF20
PF20-V
PF25
PF26
PF37
PF701B
PF702
PF702A
PF702B
PF703A
PF704
PF704A
PF705
PF705A
PF705B
PF706
PF706A
PFDS10
PFDS63



Product details

1. Diaphragm type pressure switch with DIN72585 A1-2.1 aerial connection and 300bar of maximum safety pressure.
2. Life endurance: 1000000 Times
3. Max safe pressure: 300 bar
4. Max working pressure: 150 bar

Dimensions

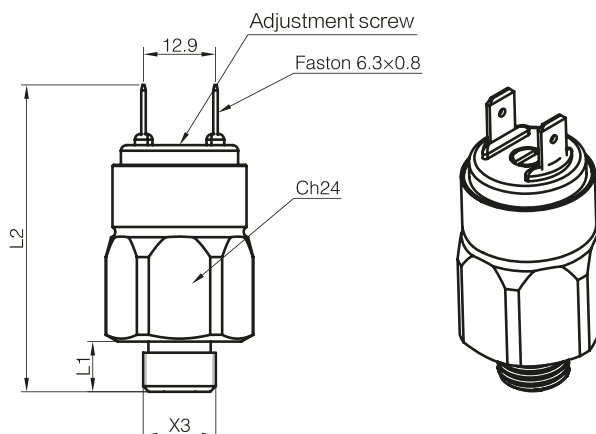

Ordering code

PF701B - A	B	C	D	E	F	G	H
Connection (X3)	L1	L2	Diaphragm	Body Material	Circuitry	Pressure range	Tolerance
G1/8	9	55	NBR	Zinc-plated steel	NO	1-5bar	±0.3bar
NPT1/8	9	55	FKM	Stainless steel	NC	1-10bar	±0.5bar
M10x1	9	55	EPDM			10-20bar	±1bar
UNF7/16	9	55	HNBR			20-50bar	±2bar
G1/4	9	55					
NPT1/4	9	55					
G1/2	12	58					

Specifications

Model	PF701B
Body	Zinc-plated steel/Stainless steel
Contact	Silver cadmium alloy, can be gold plated
Max voltage	42V
Max current	4A
Working temperature range	-40°C ~ +100°C (Based on different diaphragm)
Life endurance	10 ⁶
Electrical life endurance	10 ⁵
Pollution situation	Normal
IP Level	IP00 (Without cover)
With cover	IP54 (Rubber cover)
With cover	IP67 (Potting resin cover)
Applicable rule	EN 60730-1
Max working pressure	150bar
Burst pressure	300bar
Weight	~85gr

Conversion: 1kgf/cm²=14.2psi 1bar=14.5psi



Product details

- 1. Diaphragm type pressure switch with DIN72585 A1-2.1 aerial connection and 300bar of maximum safety pressure.
- 2. Life endurance: 1000000 Times
- 3. Max safe pressure: 600 bar
- 4. Max working pressure: 450 bar

Dimensions

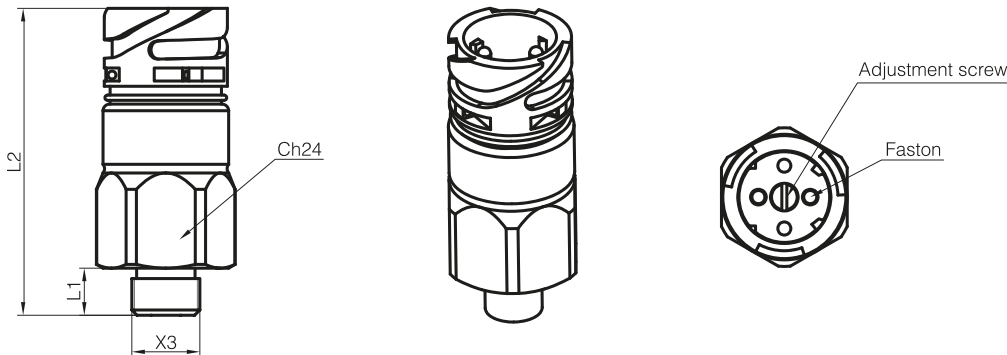

Ordering code

PF702	-	A	B	C	D	E	F	G	H
		Connection (X3)	L1	L2	O" Ring	Body Material	Circuitry	Pressure range	Tolerance
		G1/8	9	58.5	NBR	Zinc-plated steel	NO	50-150bar	±10bar
		NPT1/8	9	58.5	FKM	Stainless steel	NC	100-200bar	±15bar
		M10×1	9	58.5	EPDM				
		UNF7/16	9	58.5	HNBR				
		G1/4	9	58.5					
		NPT1/4	9	58.5					
		G1/2	12	61.5					

Specifications

Model	PF701B
Body	Zinc-plated steel/Stainless steel
Contact	Silver cadmium alloy, can be gold plated
Max voltage	42V
Max current	4A
Working temperature range	-40℃ ~ +100℃ (Based on different diaphragm)
Life endurance	10 ⁶
Electrical life endurance	10 ⁵
Pollution situation	Normal
IP Level	IP67
Applicable rule	EN 60730-1
Max working pressure	450bar
Burst pressure	600bar
Weight	~85gr

Conversion: 1kgf/cm²=14.2psi 1bar=14.5psi

Pressure Switch
T1030
T1050
T1700
T1800
T2000W
PF08
PF08A
PF08V
PF20
PF20-V
PF25
PF26
PF37
PF701B
PF702
PF702A
PF702B
PF703A
PF704
PF704A
PF705
PF705A
PF705B
PF706
PF706A
PFDS10
PFDS63

Pressure Switch

T1030
T1050
T1700
T1800
T2000W
PF08
PF08A
PF08V
PF20
PF20-V
PF25
PF26
PF37
PF701B
PF702
PF702A
PF702B
PF703A
PF704
PF704A
PF705
PF705A
PF705B
PF706
PF706A
PFDS10
PFDS63

Product details

Piston type pressure switch with M3 screw terminal and 600bar of maximum safety pressure



Dimensions

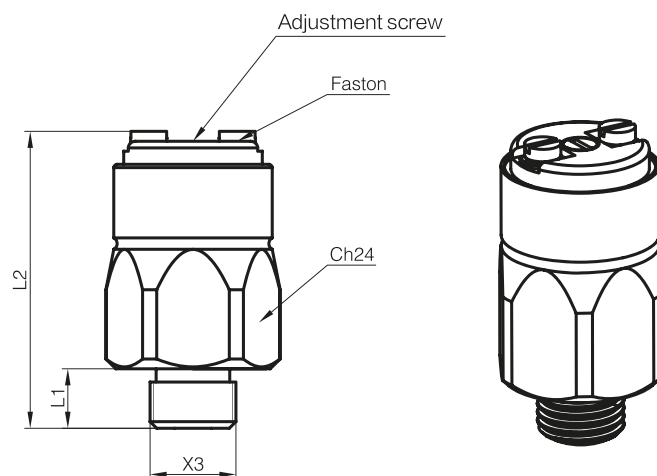

Ordering code

PF702A - A	B	C	D	E	F	G	H
Connection (X3)	L1	L2	O" Ring	Body Material	Circuitry	Pressure range	Tolerance
G1/8	9	45	NBR	Zinc-plated steel	NO	50-150bar	±10bar
NPT1/8	9	45	FKM	Stainless steel	NC	100-200bar	±15bar
M10x1	9	45	EPDM				
UNF7/16	9	45	HNBR				
G1/4	9	45					
NPT1/4	9	45					
G1/2	12	48					

Specifications

Model	PF702A
Body	Zinc-plated steel/Stainless steel
Contact	Silver cadmium alloy, can be gold plated
Max voltage	42V
Max current	4A
Working temperature range	-40°C ~ +100°C (Based on different diaphragm)
Life endurance	10 ⁶
Electrical life endurance	10 ⁵
Pollution situation	Normal
IP Level	IP00 (Without cover)
With cover	IP54 (Rubber cover)
With cover	IP67 (Potting resin cover)
Applicable rule	EN 60730-1
Max working pressure	450bar
Burst pressure	600bar
Weight	~85gr

Conversion: 1kgf/cm²=14.2psi 1bar=14.5psi

Product details

Piston type pressure switch with 6.4mm plug terminal and 600bar of maximum safety pressure



Dimensions

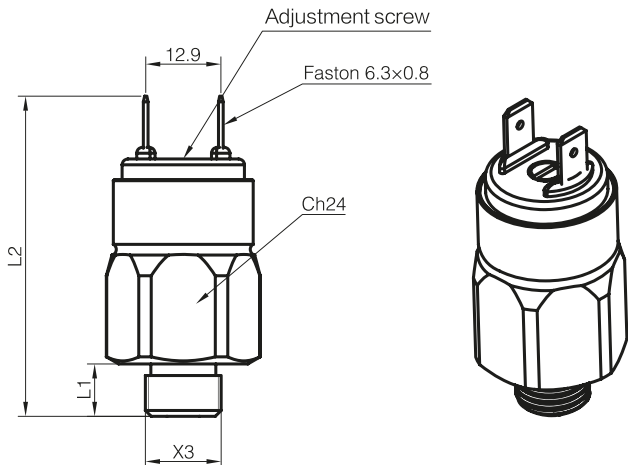

Ordering code

PF702B	-	A	B	C	D	E	F	G	H
		Connection (X3)	L1	L2	O" Ring	Body Material	Circuitry	Pressure range	Tolerance
		G1/8	9	55	NBR	Zinc-plated steel	NO	50-150bar	±10bar
		NPT1/8	9	55	FKM	Stainless steel	NC	100-200bar	±15bar
		M10×1	9	55	EPDM				
		UNF7/16	9	55	HNBR				
		G1/4	9	55					
		NPT1/4	9	55					
		G1/2	12	58					

Specifications

Model	PF702B
Body	Zinc-plated steel/Stainless steel
Contact	Silver cadmium alloy, can be gold plated
Max voltage	42V
Max current	4A
Working temperature range	-40℃~+100℃ (Based on different diaphragm)
Life endurance	10 ⁶
Electrical life endurance	10 ⁵
Pollution situation	Normal
IP Level	IP00 (Without cover)
With cover	IP54 (Rubber cover)
With cover	IP67 (Potting resin cover)
Applicable rule	EN 60730-1
Max working pressure	450bar
Burst pressure	600bar
Weight	~85gr

Conversion: 1kgf/cm²=14.2psi 1bar=14.5psi

Pressure Switch

T1030
T1050
T1700
T1800
T2000W
PF08
PF08A
PF08V
PF20
PF20-V
PF25
PF26
PF37
PF701B
PF702
PF702A
PF702B
PF703A
PF704
PF704A
PF705
PF705A
PF705B
PF706
PF706A
PFDS10
PFDS63

Pressure Switch

T1030
T1050
T1700
T1800
T2000W
PF08
PF08A
PF08V
PF20
PF20-V
PF25
PF26
PF37
PF701B
PF702
PF702A
PF702B
PF703A
PF704
PF704A
PF705
PF705A
PF705B
PF706
PF706A
PFDS10
PFDS63

Product details

Diaphragm type pressure switch 6.4mm plug terminal, SPDT and 300bar of maximum safety pressure

Dimensions

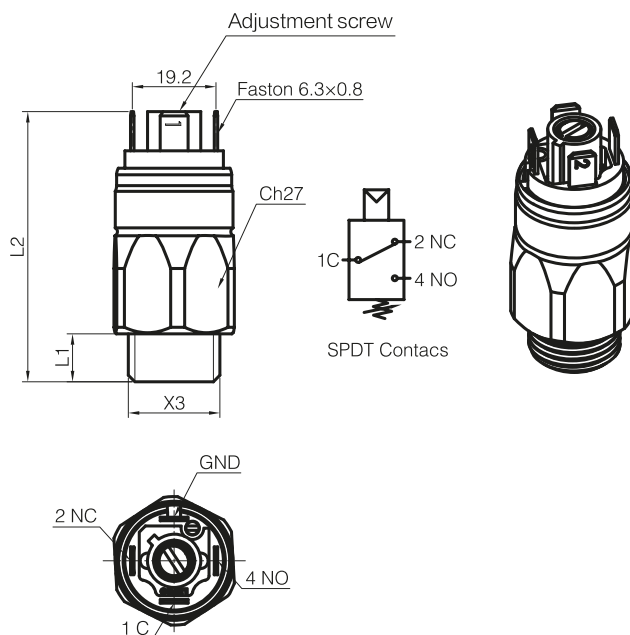

Ordering code

PF703A - A	B	C	D	E	F	G
Connection (X3)	L1	L2	Diaphragm	Body Material	Pressure range	Tolerance
G1/8	9	60	NBR	Zinc-plated steel	1-5bar	±0.3bar
NPT1/8	9	60	FKM	Stainless steel	1-10bar	±0.5bar
M10x1	9	60	EPDM		10-20bar	±1bar
UNF7/16	9	60	HNBR		20-50bar	±2bar
G1/4	9	60				
NPT1/4	9	60				
G1/2	12	63				

Specifications

Model	PF703A
Body	Zinc-plated steel/Stainless steel
Contact	Silver cadmium alloy, can be gold plated
Max voltage	250VAC/24VDC
Max current	4A
Working temperature range	-40°C ~ +100°C (Based on different diaphragm)
Life endurance	10 ⁶
Electrical life endurance	10 ⁵
Pollution situation	Normal
IP Level	IP65
Applicable rule	EN 60730-1
Max working pressure	150bar
Burst pressure	300bar
Weight	~95gr

Conversion: 1kgf/cm²=14.2psi 1bar=14.5psi

Product details

1. Piston type pressure switch with DIN43650-A Hirschman connection, SPDT and 600bar of maximum safety pressure.
2. Max safe pressure: 600 bar
3. Max working pressure: 450 bar



Dimensions

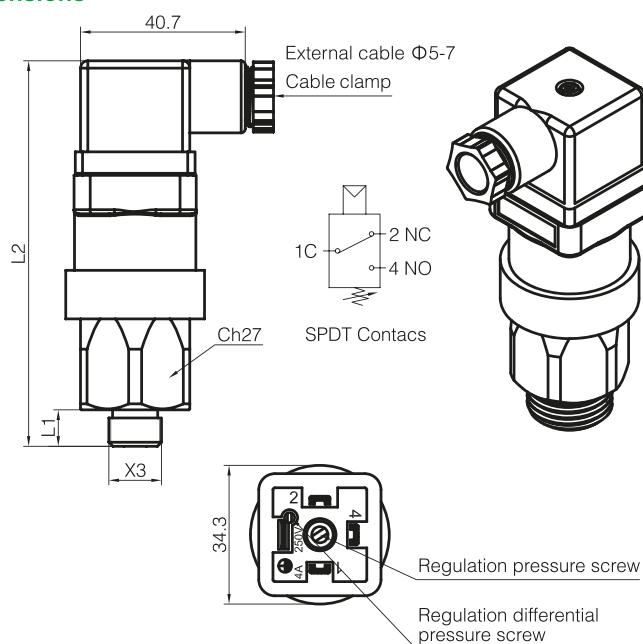

Ordering code

PF704	A	B	C	D	E	F	G	H
	Connection (X3)	L1	L2	Diaphragm	Body Material	Circuitry	Pressure range	Tolerance
	G1/8	9	95	NBR	Zinc-plated steel	NO	50-150bar	±10bar
	NPT1/8	9	95	FKM	Stainless steel	NC	100-200bar	±15bar
	M10×1	9	95	EPDM				
	UNF7/16	9	95	HNBR				
	G1/4	9	95					
	NPT1/4	9	95					
	G1/2	12	98					

Specifications

Model	PF704
Body	Zinc-plated steel/Stainless steel
Contact	Silver cadmium alloy, can be gold plated
Max voltage	250VAC/24VDC
Max current	4A
Working temperature range	-40℃ ~ +100℃ (Based on different diaphragm)
Life endurance	10 ⁶
Electrical life endurance	10 ⁵
Pollution situation	Normal
IP Level	IP65
Applicable rule	EN 60730-1
Max working pressure	450bar
Burst pressure	600bar
Weight	~140gr

Conversion: $1\text{kgf/cm}^2=14.2\text{psi}$ $1\text{bar}=14.5\text{psi}$

Pressure Switch

T1030

T1050

T1700

T1800

T2000W

PF08

PF08A

PF08V

PF20

PF20-V

PF25

PF26

PF37

PF701B

PF702

PF702A

PF702B

PF703A

PF704

PF704A

PF705

PE705A

PE705B

PE706

DE306A

BEDS10

BEDC62

Pressure Switch

T1030
T1050
T1700
T1800
T2000W
PF08
PF08A
PF08V
PF20
PF20-V
PF25
PF26
PF37
PF701B
PF702
PF702A
PF702B
PF703A
PF704
PF704A
PF705
PF705A
PF705B
PF706
PF706A
PFDS10
PFDS63



Product details

1. Piston type pressure switch with DIN43650-A Hirschman connection, SPDT and 600bar of maximum safety pressure.
2. Max safe pressure: 600 bar
3. Max working pressure: 450 bar

Dimensions

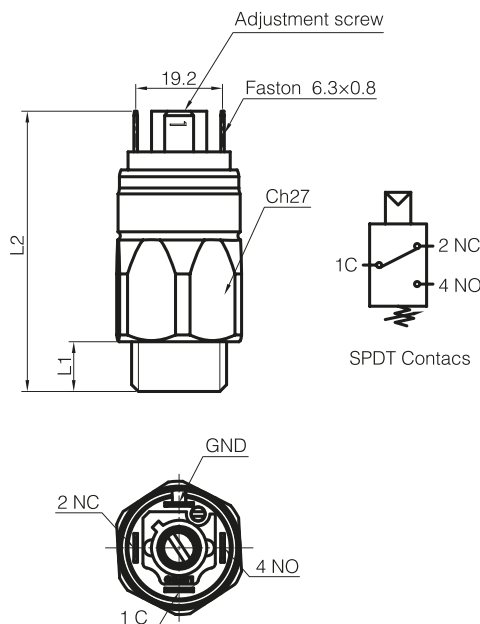

Ordering code

PF704A - A	B	C	D	E	F	G
Connection (X3)	L1	L2	O" Ring	Body Material	Pressure range	Tolerance
G1/8	9	60	NBR	Zinc-plated steel	50-150bar	±10bar
NPT1/8	9	60	FKM	Stainless steel	100-200bar	±15bar
M10x1	9	60	EPDM			
UNF7/16	9	60	HNBR			
G1/4	9	60				
NPT1/4	9	60				
G1/2	12	63				

Specifications

Model	PF704A
Body	Zinc-plated steel/Stainless steel
Contact	Silver cadmium alloy, can be gold plated
Max voltage	250VAC/24VDC
Max current	4A
Working temperature range	-40°C ~ +100°C (Based on different diaphragm)
Life endurance	10 ⁶
Electrical life endurance	10 ⁵
Pollution situation	Normal
IP Level	IP00
Applicable rule	EN 60730-1
Max working pressure	450bar
Burst pressure	600bar
Weight	~95gr

Conversion: 1kgf/cm²=14.2psi 1bar=14.5psi

Product details

Diaphragm type pressure switch with 6.4mm plug terminal, brass body and 80bar of maximum safety pressure

Dimensions

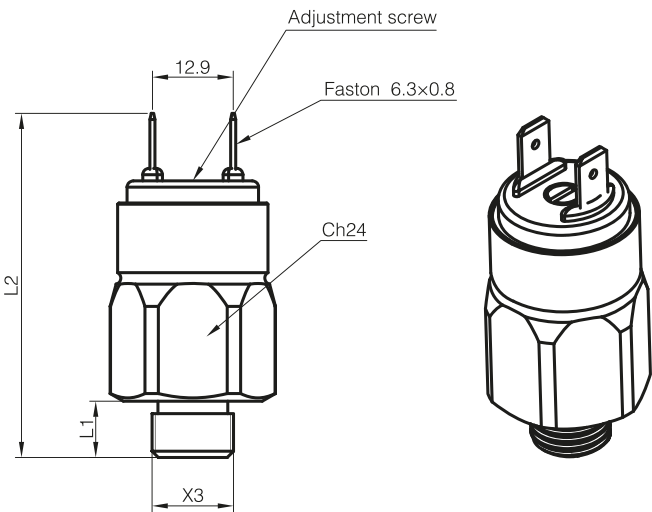

Ordering code

PF705	-	A	B	C	D	E	F	G
		Connection (X3)	L1	L2	O" Ring	Circuitry	Pressure range	Tolerance
		G1/8	9	55	NBR	NO	1-5bar	±0.3bar
		NPT1/8	9	55	FKM	NC	1-10bar	±0.5bar
		M10x1	9	55	EPDM		10-20bar	±1bar
		UNF7/16	9	55	HNBR			
		G1/4	9	55				
		NPT1/4	9	55				
		G1/2	12	58				

Specifications

Model	PF705
Body	Brass
Contact	Silver cadmium alloy, can be gold plated
Max voltage	42V
Max current	4A
Working temperature range	-40°C ~ +100°C (Based on different diaphragm)
Life endurance	10 ⁶
Electrical life endurance	10 ⁵
Pollution situation	Normal
IP Level	IP00 (Without cover)
With cover	IP54 (Rubber cover)
With cover	IP67 (Potting resin cover)
Applicable rule	EN 60730-1
Max working pressure	40bar
Burst pressure	80bar
Weight	~85gr

Conversion: 1kgf/cm²=14.2psi 1bar=14.5psi

Pressure Switch

T1030

T1050

T1700

T1800

T2000W

PF08

PF08A

PF08V

PF20

PF20-V

PF25

PF26

PF37

PF701B

PF702

PF702A

PF702B

PF703A

PF704

PF704A

PF705

PF705A

PF705B

PF706

PF706A

PFDS10

PFDS63

Pressure Switch

T1030
T1050
T1700
T1800
T2000W
PF08
PF08A
PF08V
PF20
PF20-V
PF25
PF26
PF37
PF701B
PF702
PF702A
PF702B
PF703A
PF704
PF704A
PF705
PF705A
PF705B
PF706
PF706A
PFDS10
PFDS63

Product details

Diaphragm type pressure switch with 6.4mm plug terminal, brass body and 80bar of maximum safety pressure

Dimensions

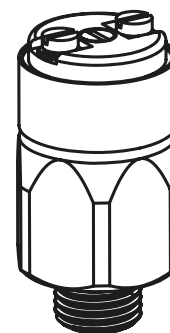
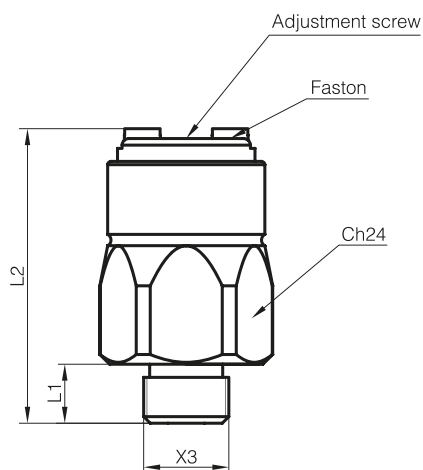

Ordering code

PF705A - A	B	C	D	E	F	G
Connection (X3)	L1	L2	Diaphragm	Circuitry	Pressure range	Tolerance
G1/8	9	45	NBR	NO	1-5bar	±0.3bar
NPT1/8	9	45	FKM	NC	1-10bar	±0.5bar
M10x1	9	45	EPDM		10-20bar	±1bar
UNF7/16	9	45	HNBR			
G1/4	9	45				
NPT1/4	9	45				
G1/2	12	48				

Specifications

Model	PF705A
Body	Brass
Contact	Silver cadmium alloy, can be gold plated
Max voltage	42V
Max current	4A
Working temperature range	-40°C ~ +100°C (Based on different diaphragm)
Life endurance	10 ⁶
Electrical life endurance	10 ⁵
Pollution situation	Normal
IP Level	IP00 (Without cover)
With cover	IP54 (Rubber cover)
With cover	IP67 (Potting resin cover)
Applicable rule	EN 60730-1
Max working pressure	40bar
Burst pressure	80bar
Weight	~85gr

Conversion: 1kgf/cm²=14.2psi 1bar=14.5psi

Product details

Diaphragm type pressure switch with DIN72585 A1-2.1 connection, brass body and 80bar of maximum safety pressure



Dimensions

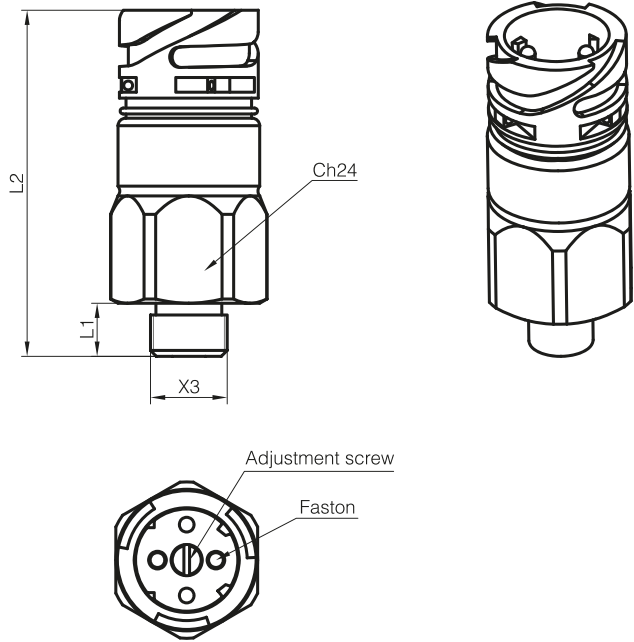

Ordering code

PF705B	A	B	C	D	E	F	G
	Connection (X3)	L1	L2	Diaphragm	Circuitry	Pressure range	Tolerance
	G1/8	9	58.5	NBR	NO	1-5bar	±0.3bar
	NPT1/8	9	58.5	FKM	NC	1-10bar	±0.5bar
	M10×1	9	58.5	EPDM		10-20bar	±1bar
	UNF7/16	9	58.5	HNBR			
	G1/4	9	58.5				
	NPT1/4	9	58.5				
	G1/2	12	61.5				

Specifications

Model	PF705B
Body	Brass
Contact	Silver cadmium alloy, can be gold plated
Max voltage	42V
Max current	4A
Working temperature range	-40℃~+100℃ (Based on different diaphragm)
Life endurance	10 ⁶
Electrical life endurance	10 ⁵
Pollution situation	Normal
IP Level	IP00 (Without cover)
Applicable rule	EN 60730-1
Max working pressure	40bar
Burst pressure	80bar
Weight	~85gr

Conversion: 1kgf/cm²=14.2psi 1bar=14.5psi

Pressure Switch

T1030

T1050

T1700

T1800

T2000W

PF08

PF08A

PF08V

PF20

PF20-V

PF25

PF26

PF37

PF701B

PF702

PF702A

PF702B

PF703A

PF704

PF704A

PF705

PF705A

PF705B

PF706

PF706A

PFDS10

PFDS63

Pressure Switch

T1030
T1050
T1700
T1800
T2000W
PF08
PF08A
PF08V
PF20
PF20-V
PF25
PF26
PF37
PF701B
PF702
PF702A
PF702B
PF703A
PF704
PF704A
PF705
PF705A
PF705B
PF706
PF706A
PFDS10
PFDS63



Product details

Diaphragm type pressure switch with DIN 43650-A Hirschman connection, brass body and 80bar of maximum safety pressure

Dimensions

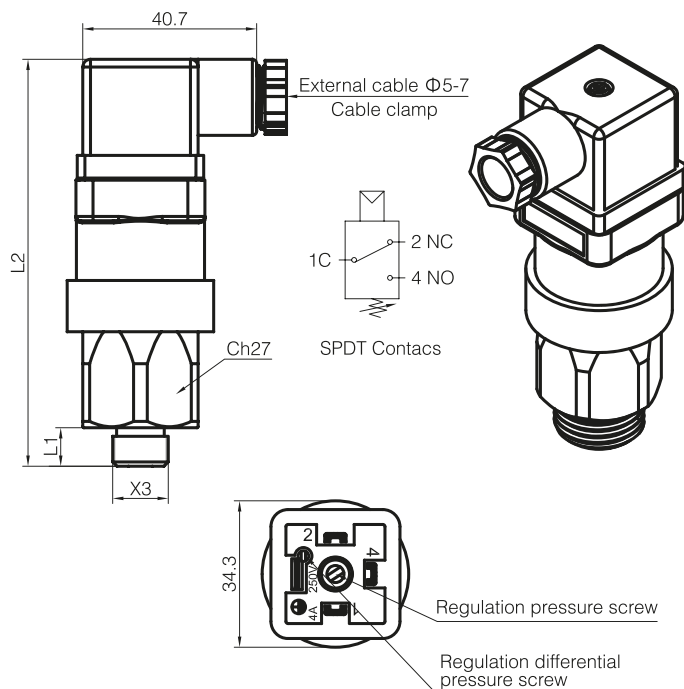

Ordering code

PF706	A	B	C	D	E	F
	Connection (X3)	L1	L2	Diaphragm	Pressure range	Tolerance
	G1/8	9	95	NBR	1-5bar	±0.3bar
	NPT1/8	9	95	FKM	1-10bar	±0.5bar
	M10x1	9	95	EPDM	10-20bar	±1bar
	UNF7/16	9	95	HNBR		
	G1/4	9	95			
	NPT1/4	9	95			
	G1/2	12	98			

Specifications

Model	PF706
Body	Brass
Contact	Silver cadmium alloy, can be gold plated
Max voltage	42V
Max current	4A
Working temperature range	-40°C ~ +100°C (Based on different diaphragm)
Life endurance	10 ⁶
Electrical life endurance	10 ⁵
Pollution situation	Normal
IP Level	IP00 (Without cover)
Applicable rule	EN 60730-1
Max working pressure	40bar
Burst pressure	80bar
Weight	~140gr

Conversion: 1kgf/cm²=14.2psi 1bar=14.5psi

Product details

Diaphragm type pressure switch with 6.4 mm plug terminal, brass body and 80 bar of maximum safety pressure

Dimensions

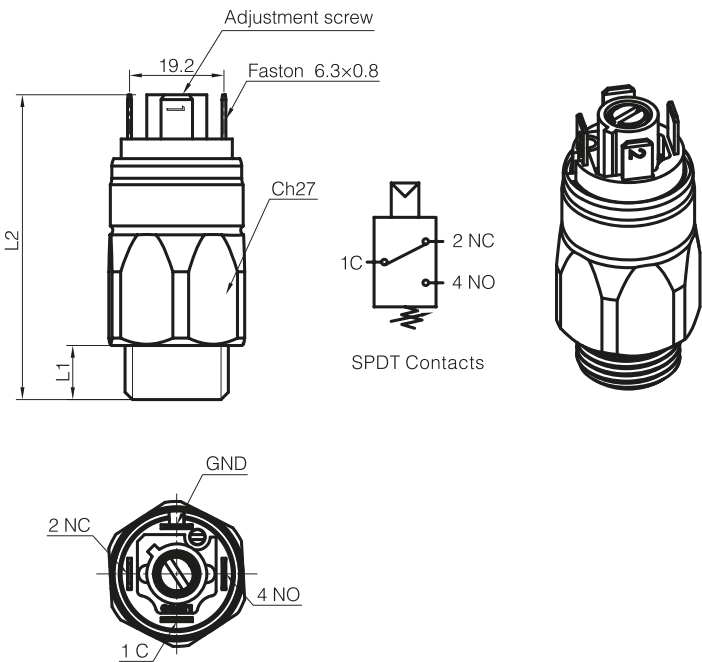

Ordering code

PF706A	A	B	C	D	E	F
	Connection (X3)	L1	L2	Diaphragm	Pressure range	Tolerance
	G1/8	9	60	NBR	1-5bar	±0.3bar
	NPT1/8	9	60	FKM	1-10bar	±0.5bar
	M10×1	9	60	EPDM	10-20bar	±1bar
	UNF7/16	9	60	HNBR		
	G1/4	9	60			
	NPT1/4	9	60			
	G1/2	12	63			

Specifications

Model	PF706A
Body	Brass
Contact	Silver cadmium alloy, can be gold plated
Max voltage	42V
Max current	4A
Working temperature range	-40℃ ~ +100℃ (Based on different diaphragm)
Life endurance	10 ⁶
Electrical life endurance	10 ⁵
Pollution situation	Normal
IP Level	IP00 (Without cover)
Applicable rule	EN 60730-1
Max working pressure	40bar
Burst pressure	80bar
Weight	~105gr

Conversion: 1kgf/cm²=14.2psi 1bar=14.5psi

Pressure Switch
T1030
T1050
T1700
T1800
T2000W
PF08
PF08A
PF08V
PF20
PF20-V
PF25
PF26
PF37
PF701B
PF702
PF702A
PF702B
PF703A
PF704
PF704A
PF705
PF705A
PF705B
PF706
PF706A
PFDS10
PFDS63

Pressure Switch

T1030
T1050
T1700
T1800
T2000W
PF08
PF08A
PF08V
PF20
PF20-V
PF25
PF26
PF37
PF701B
PF702
PF702A
PF702B
PF703A
PF704
PF704A
PF705
PF705A
PF705B
PF706
PF706A
PFDS10
PFDS63



Product details

1. LFDS101/LFDS102 Series can measure the pressure with high reliability sensor. After processing by the back-end circuit, the signal will be converted into a standard industrial electrical signal.
2. Then it will be output and displayed. These products have plastic shell design, high contrast, double screen digital display LCD. So this series of products can be used in various industrial applications.
3. The product with 3 key design and user friendly menu will be more convenient to use. Different connections can fully meet the specific installation requirements. Users can adjust the working parameters of built-in set items. That is very flexible and convenient.
4. The characteristics of this series are shock resistant, long service life, simple operation and clear display.

Dimensions

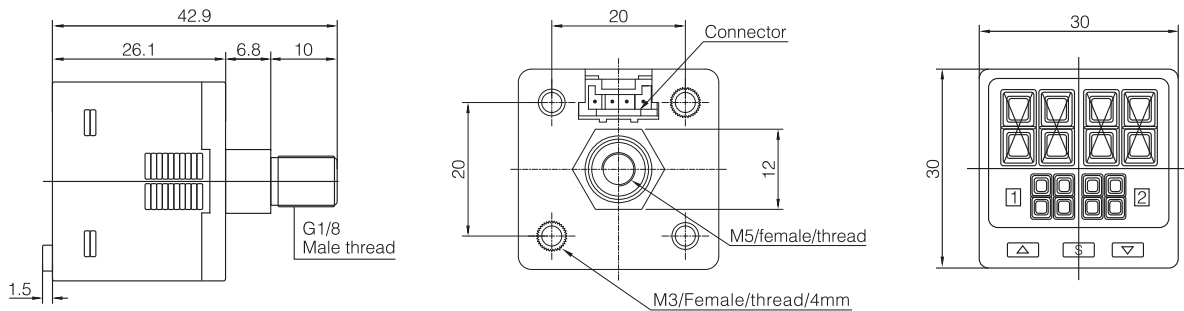

Ordering code

PFDS10		1	—	S	—	E	—	N	—	W
		Pressure range	Output characters (Note 1)		Connection type		Switching valve type		Special status (Note 2)	
1	High pressure type (-100~1000kPa)	S	Standard type	R	R1/8+M5 Female screw	N	NPN	W	No	
		A	Current output type	E	G1/8+M5 Female screw	P	PNP	X	Special specification	
2	Low pressure type (-100~100kPa)	V	Voltage output type	M	M=M5 Female screw			J	Customized	

Note 1: Standard type: 2 switch interface (PNP or NPN); Current type: 1 switch interface (PNP or NPN) + 1 analogue (4-20mA);

Voltage type: 1 switch interface (PNP or NPN) + 1 analogue(1-5V).

2: Any question, please contact us.

Specifications

Item\Model	PFDS101	PFDS102
Pressure type	Standard pressure	
Pressure range	(-100~1000kPa)	(-100~1000kPa)
Proof pressure	1.5 Times	3 Times
Media	Non-hazardous gas only	
Rated voltage	12~24VDC	
Current consumption	<20mA (When no load)	
Switch output	<NPN Output type>: NPN open collector transistor, Max current: 100mA, Pressure drop: <1.5V <PNP Output type>: PNP open collector transistor, Max current: 100mA, Pressure drop: <1.5V	
Output setting	NO/NC	
Hysteresis	1-8 Level (Default 3 Level)	
Repeatability	±0.3% F.S	
Comprehensive precision	±1% F.S	
Response time	2.5/5/10/25/250/500/1000/5000ms	
Analog voltage output	1-5V ±5% (Limit for current output type)	
Analog current output	4-20mA ±5% (Limit for voltage output type)	
Storage temperature	-10~60℃	
Operating temperature	0~50℃	
Temperature character	±2.5% F.S	
Enclosure	CN-14A-C2 (With connector cable, 2m)	

Conversion: 1kgf/cm²=14.2psi 1bar=14.5psi



Product details

- 1. PFDS630 (630/631/632) series is made by high-reliability sensor to measure pressure.
- 2. After disposed by back-end circuit, the signal shows on displayer and automatically control relay output when pressure changes.
- 3. With design of engineering plastic shell and high-contrast LCD displayer, this series product can be used in various industrial fields.
- 4. Kinds of connection types can meet different installation requirements.
- 5. User can adjust parameters freely, with variety of settings built-in, it's flexible and convenient.
- 6. PFDS63 (630/631/632) series is with features of anti-vibration, long lifetime, easy operation, high stability and clear display.

Dimensions

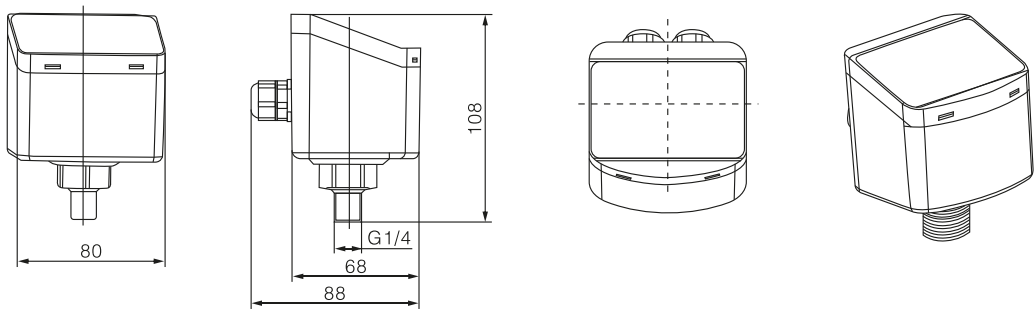

Relay working mode

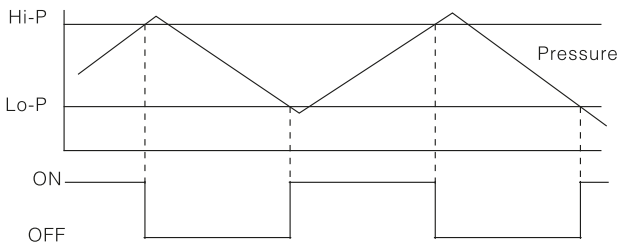

Hi-P: OFF pressure value Lo-P: ON pressure value
The controller will monitor pressure in container in real time, to control pressure by ON/OFF setting.
User also can use manual set to change parameters and lock protection (Refer to operating instruction).

Ordering code

PFDS63 0		S		T		R	
Pressure range		Output		Special function		Connection	
2	Mid-pressure(0~2.0MPa)	No code(default)	Single AC220V output	No code(default)	No	No	G1/4
1	Low-pressure(0~1.0MPa)	S	Single relay switch output	T	Intelligent time control	N	NPT1/4
0	Vacuum(-101.3~10.KPa)	D	Double relay switch output			R	R1/4

Specifications

Item\Model	PFDS630	PFDS631	PFDS632
Pressure range	(-101.3~10kPa)	(0-1.0~10MPa)	(0~2MPa)
Proof pressure	1.5 Times	2 Times	
Medium	Air, noncorrosive gas and oil, water		
Rated working voltage	220VAC		
Power consumption	1.3W (No Load)		
Load	200VAC 10A (Max)		
IP Class	IP52		
Connection	G1/4, NPT1/4, R1/4		
Accuracy	±1% F.S		
Storage temperature	-10~60℃		
Operation temperature	10~50℃		
Dimension	80×88×110mm (With connection)		

Conversion: 1kgf/cm²=14.2psi 1bar=14.5psi

Pressure Switch

T1030

T1050

T1700

T1800

T2000W

PF08

PF08A

PF08V

PF20

PF20-V

PF25

PF26

PF37

PF701B

PF702

PF702A

PF702B

PF703A

PF704

PF704A

PF705

PF705A

PF705B

PF706

PF706A

PFDS10

PFDS63